

752-1

1. Considered 7-14, 1965
2. Name of Applicant FISH & WILDLIFE SERVICE
3. Post Office Address MINNEAPOLIS
4. Amount of Water Claimed 1.79
5. Source of water supply SPECIAL GROUND WATER (SPEARFISH)
6. Water to be used for FISH CULTURE
 Acres to be irrigated —
7. Water to be diverted and used in LAWRENCE County about
4 1/2 Miles SW of SPEARFISH
8. Proof of Publication Received ✓
 Not Received _____
9. Application Approved _____
 Subject to _____
 Not Approved _____
 Action deferred _____

10. Remarks:

No. 752-1

Water Division No. 1 BELLE FOURCHE RIVER
(Blanks to be Filled by the Engineer for the W. R. C.)

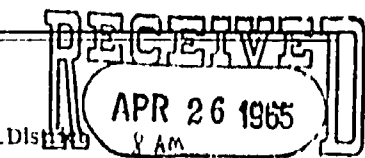

STATE WATER RESOURCES COM.
PIERRE, SOUTH DAKOTA

APPLICATION FOR PERMIT

To Appropriate Water within the State of South Dakota

(NOTE—Draw a line through items not applicable.)

1. Name of applicant R. W. Burwell, Regional Director, U. S. Dept. of Interior, Bureau of Sport Fisheries & Wildlife, Acting on behalf of the U. S. of America
1006 West Lake Street
Postoffice address Minneapolis (55408), County Hennepin, State Minnesota

I. ~~With/without~~ United States Government.

- (a) Name of same _____
- (b) Date and place of incorporation _____
- (c) Amount of capital stock _____
- (d) Amount paid in _____
- (e) Names and addresses of directors _____

(NOTE—A certified copy of articles of incorporation must accompany the application.)

II. Method of accomplishing the work and financial resources of the applicant:

- (a) Method of accomplishing work (Whether by contract, employment of others, or by direct labor)
Contract (anticipate funds to be available after July 1, 1965)
- (b) Cash on hand, \$ _____
- (c) Treasury stock, \$ _____
- (d) Bonds to be issued, \$ _____
- (e) Other resources, \$ _____ Regional Appropriation

2. Name of diversion work 10-inch artesian well - McNenny National Hatchery

3. Amount of water claimed 1 79 cubic feet per second or 869 gpm

4. Source of water supply Spearfish formation
NE 1/4 NE 1/4, Sec. 20, T.7N., R.1E.

5. Location of point of diversion (see Exhibit "A" attached) Adjacent to Crow Creek which in turn is tributary to Redwater Creek on right bank Lawrence County.

6. Annual period or periods during which water is to be used January 1 to December 31

7. To be used for:

- I. Irrigation or domestic use: Gravity, overhead sprinkling or combination system? _____
- (a) Number of acres to be irrigated _____ acres.
- (b) Legal subdivisions to be irrigated _____
- (NOTE—A list of lands to be irrigated, giving each subdivision and fraction with acreage thereof, should be written here, or may be appended as a part of this application. Same must also be shown on accompanying map.)
- (c) Statement as to domestic use (giving location, etc.) fish culture and NW 1/4 NW 1/4, Section 21, T.7N., R.1E., Lawrence County, South Dakota

II. Stockwatering, mining, milling, power, fish culture, fire protection and public recreation:

- (a) Nature of use fish culture and domestic
Name any of the above uses claimed
- (b) Amount of power to be generated _____ horse power.
Amount claimed for engine cooling _____
- (c) Location of plant _____
- (d) Method of developing power _____
- (e) Point where water will be returned to stream NW 1/4 NW 1/4, Sec. 21, T.7N., R.1E.

MAP NO 631-1

8. Estimated cost of work:

(a) Head Gates, \$..... (b) Pumping plant, \$.....
 (c) Fluming, \$..... (d) Canal earth, \$..... Rock, \$.....
 (e) Other structures \$..... Total, \$.....

9. Description of diversion works:

I. Nature of works: *(Rear of NW 1/4 Sec 10 T14N R10W S10E)* 10-inch artesian well

II. Dimensions of works:

(a) Dam: Height.....feet; length at bottom.....feet; length at top.....feet; thickness at bottom.....feet; thickness at top.....feet; slope at front water face.....; slope at back face..... material used in construction.....
 (b) Reservoir: Capacity when filled.....acre feet. Surface area at high water mark.....acres.

DEPTH AT PUMP	WELL CAPACITY (gpm)	ACRE-FOOT CAPACITY (DAILY)
Artesian	800	3.58
total	800	3.58

(c)* Head gate: Width.....feet; height.....feet;

Material.....

(d) Canal: Total length.....miles.

LOCATION BELOW HEADGATE	DEPTH	BOTTOM WIDTH	WIDTH AT WATER-LINE	GRADE PER MILE
At.....Milefeetfeetfeetfeet
At.....Milefeetfeetfeetfeet
At.....Milefeetfeetfeetfeet
At.....Milefeetfeetfeetfeet
At.....Milefeetfeetfeetfeet
At.....Milefeetfeetfeetfeet

(Give dimensions where reductions in size are made.)

10. Time required for completion of work.....one.....year/s from July 1, 1965

11. Time required for complete application of water to the proposed beneficial use.....one.....year/s from July 1, 1966

12. Choice of newspaper for publication of notice of intention to appropriate.....Spearfish.....

STATE OF ~~SOUTH DAKOTA~~ ^{MINNESOTA} }
 County of Hennepin } ss.

I, R. W. Burwell, being first duly sworn on my oath depose and say: That my relation to the above described undertaking is that of owner, that I have read the above foregoing statement, examined the map accompanying the same, and that I know of my own personal knowledge, that the matters therein stated and shown are true.

Signed R. W. Burwell
 s/ R. W. Burwell, Regional Director

Subscribed and sworn to before me this 23 day of April 1965

William J. Schmitz
 Notary Public (or other qualified officer.)

*Each diversion must have a headgate or measuring device.

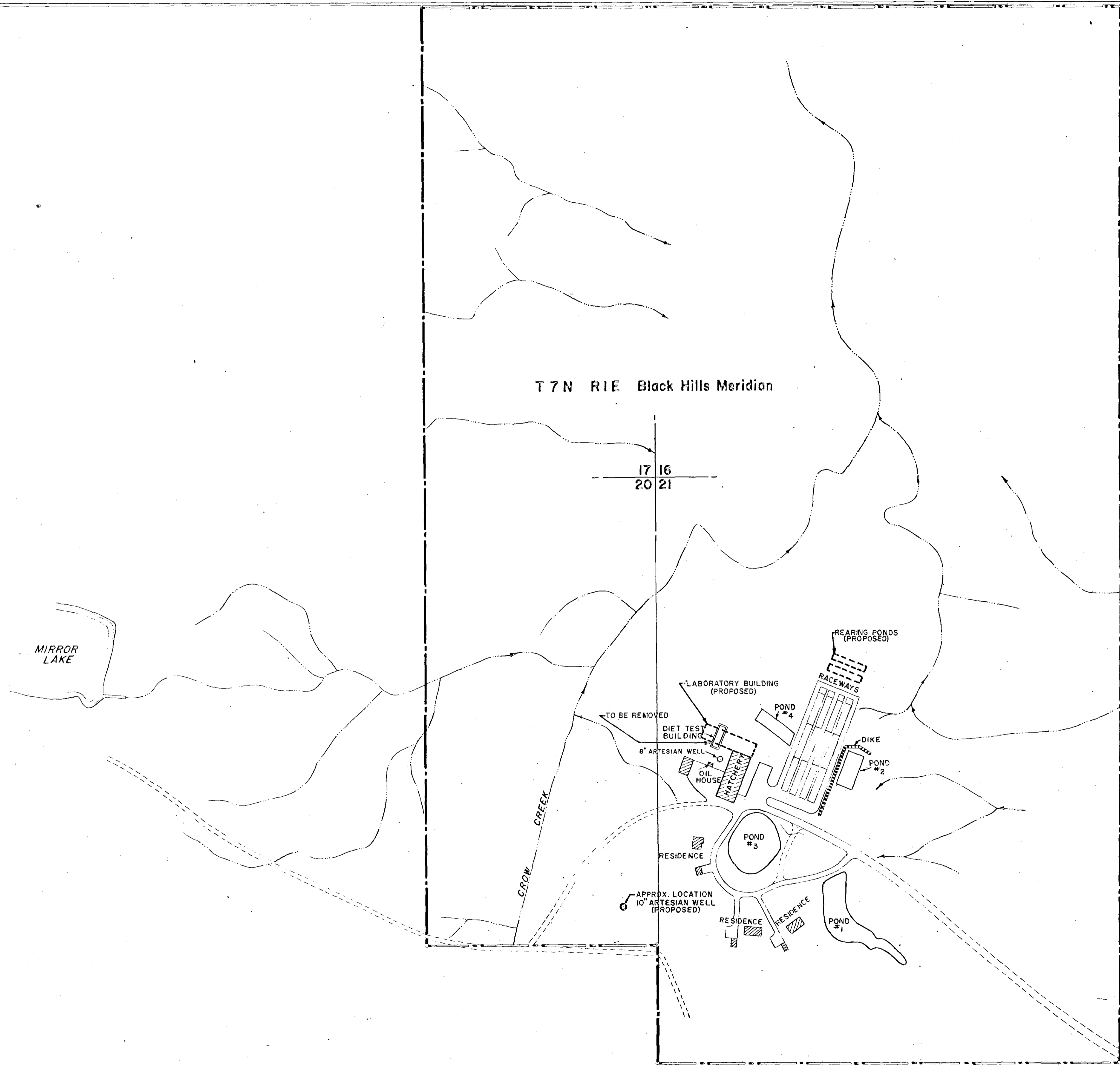

SCALE: 1" = 150'

Certificate of Engineer or Surveyor
 This map was compiled from official plats of the Bureau of Land Management and from Surveys by the Bureau of Sport Fisheries and Wildlife in June 1948, and from other notes and data on record in this office

Frank S. Hammings, Jr.
 Frank S. Hammings, Jr.
 Civil Engineer
 Branch of Engineering

STATE OF MINNESOTA)
 COUNTY OF HENNEPIN) ss.

The above affidavit was subscribed and sworn to before me, a Notary Public, this 5th day of April 1965

Linnie F. Thomas

LINNIE F. THOMAS
 Notary Public, Hennepin County, Minn.
 My Commission Expires April 16, 1970.

REVISIONS		DATE	DRAWN
UNITED STATES DEPARTMENT OF THE INTERIOR FISH AND WILDLIFE SERVICE BUREAU OF SPORT FISHERIES AND WILDLIFE BRANCH OF ENGINEERING			
SUBMITTED	McNENNY		
REGIONAL ENGINEER	NATIONAL FISH HATCHERY		
REVIEWED	LAWRENCE COUNTY	SOUTH DAKOTA	
RECOMMENDED	LOCATION MAP		
REGIONAL DIRECTOR	DESIGNED	DRAWN G.A.C. DATE 2-65	CHECKED
W.O. APPROVAL DATE	MINNEAPOLIS, MINN.	DRAWING NO.	

Exhibit A To South Dakota
 Water Right Application - 1965 (No. 2)

SHEET ___ OF ___

MAP No 631-1 (APPL No 752-1)

Remarks by State Water Resources Commission:

THIS WELL MUST BE VALVED AND CLOSED WHEN WATER IS NOT BEING USED. THIS WELL IS IN AN ARTESIAN BASIN HAVING LIMITED SUPPLIES, AND RESTRICTIONS AS TO FLOW AND TIME OF FLOW MAY BE MADE BY THE COMMISSION TO PROTECT PRIOR WATER RIGHTS. IF, AT ANY TIME, THIS PERMIT IS CANCELLED OR THE WELL ABANDONED, THE WELL MUST BE PLUGGED TO THE SATISFACTION OF

STATE OF SOUTH DAKOTA
County of HUGHES

ss. THE COMMISSION.

Pierce, South Dakota, JULY 20, 1965

This is to certify that the foregoing application was received by the Commission at 8:00 o'clock 9 a.m. upon the 26TH day of APRIL, 1965

State Water Resources Commission

By: [Signature]
for Chief Engineer, Executive Officer

Number of permit 752-1

Date of first receipt of application APRIL 26, 1965

Date of return to applicant for correction, amendments or changes required as follows: ---, 19---

Date of receipt of corrected application ---, 19---

Date from which applicant may claim right APRIL 26, 1965

Approved JULY 14, 1965, Recorded in Book 9 Page 35

This is to certify that we have examined the foregoing application for a permit to appropriate water of the State of South Dakota, and we hereby grant the same as stated herein subject, however, to the following limitations and conditions:

1st. The equivalent of at least one-fifth of the work above specified is to be completed on or before JANUARY 1, 1966

2nd. The whole of said work is to be completed on or before JULY 1, 1966

3rd. The limit of time for proof of beneficial use of water appropriated in accordance herewith is JULY 1, 1967

4th. The water appropriated shall be used for the purpose of FISH CULTURE

5th. The prior right of all persons who, by compliance with the laws of the State of South Dakota, have acquired a right to the use of water must not be injuriously affected by this appropriation.

6th. The amount of the appropriation herein granted shall not exceed 1.79 cubic feet per second; neither shall it exceed the capacity of the above described system of diversion works, nor the least amount of water that experience may hereafter indicate as necessary for the production of crops in the exercise of the best husbandry; and further, said appropriation must be limited to not more than one-eighth (1/8) of one cubic foot of water per second of time for each acre of land on which water is actually USED FOR FISH CULTURE PURPOSES and beneficially applied on or before JULY 1, 1967; said water to be used during the following described annual period:

CONTINUOUSLY

Witness my hand this 20TH day of JULY, 1965

State Water Resources Commission

By: [Signature]
Chief Engineer, Executive Officer

Certificate of Construction Issued JUNE 8, 1967

Water License Issued JUNE 8, 1967

Form 3A — Wells (Supplement to Form 2)

9. (Continued)

III. Well Specifications

(a) Hole and casing

* Size of drill hole or excavation 13" Depth 430' approx.

* Type of casing steel
(wood, concrete, steel, etc.)

Size of casing 10" Thickness of casing 0.279

Length of casing ... 355 feet If collection gallery, length, size and depth of
gallery *17-inch drill hole to 50' depth, 13-inch drillhole to 430'
depth, 14-inch casing to 50', 10-inch casing to 355' Grouted
between 14 and 10-inch casings and between both casing & the open hole to 355'.

(b) Screens

Type of perforated screen no screen - 75 feet of open hole

Size of perforated screen
(diameter) (length)

Thickness of gravel pack none length of gravel pack

(c) Water Bearing Materials

Distance to water artesian Character of water bearing materials sandstone-
Spearfish red shale

Thickness of water bearing material 430 feet approximately

(d) Pump and Motor

Type of pump none - artesian flow
(centrifugal, propeller, mixed flow, etc.)

Name of pump size

Kind of motor
(gasoline, electric, diesel, etc.)

Horsepower Name of Motor

(e) Complete well:

Capacity ... 800 gpm at drawdown of none Estimated cost

(f) Owner of land upon which well is located State of South Dakota
Dept. of Game, Fish & Parks
Name

Address

(g) Distance to nearest existing wells

Exhibit "A" tract north
On ~~the owner's property~~ 30 rods. On property owned by others approx. 220 rods

STATE OF SOUTH DAKOTA

WATER LICENSE No. 752-1

WHEREAS, On the 26th day of April A. D. 1965

the Bureau of Sport Fisheries and Wildlife

of Minneapolis County of Bannock and State of

Minnesota duly made application (No. 752-1) to us for a permit to use 1.79

cubic feet per second of the waters of artesian ground water

County of Lawrence, State of South Dakota, for fish culture purposes; and

WHEREAS, On the 20th day of July A. D. 1965

Permit No. 752-1 was issued to said applicant for the diversion of said water, and providing for the completion of the works of diversion therein described on or before the 1st day of

July A. D. 1966 and for the application to beneficial use of said

water on or before the 1st day of July A. D. 1967 and,

WHEREAS, On the 2nd day of June A. D. 1967

the holder of said permit duly made proof of the completion of adequate works for the diversion of 2.9

cubic feet per second of said waters, as evidenced by our Certificate No. 752-1

dated June 8, 1967 confirming the completion of works of sufficient capacity for

diverting and conveying to the place of intended use 2.9 cubic feet per second of water, with date of

priority of April 26, 1965 and,

WHEREAS, On the 2nd day of June A. D. 1967

proof was duly made of the application to beneficial use of 1.79 cubic feet per second of said water;

for operation of the fish hatchery

NOW, THEREFORE, By the virtue of the authority vested in us by the laws of the State of South Dakota, We hereby grant and confirm to the Bureau of Sport Fisheries and Wildlife

of Minneapolis the holder and owner of said permit No. 752-1

a water right, dating from April 26, 1965 to the use of 1.72

cubic feet per second of the waters of artesian ground water

in the County of Lawrence and State of South Dakota, or so much thereof as may be

necessary for the purposes hereinbelow mentioned, to be diverted at a point in the NW 1/4 NW 1/4 Section 21, T7N, R1E

and conducted to and ~~xxxx~~ through the fish hatchery

for the purpose of fish culture

subject, however, to the laws of the State of South Dakota applicable to a license for the use of the waters of the State, and subject, also to the local or community customs, rules and regulations which have been or may be adopted from time to time by a majority of the users from a common source of supply, canal or lateral from which such water may be taken, when such rules and regulations have for their object the economical use of such water.

WITNESS, My hand and seal of our office at Pierre, South Dakota, this 8th day of June A. D. Nineteen Hundred and Sixty-Seven

State Water Resources Commission

By:

J. W. GRIMES
Chief Engineer, Executive Officer

STATE OF SOUTH DAKOTA

Water License No. -----

To -----

Source of Supply -----

County -----

Am't ----- c. f. s.

Point of Diversion -----

Place of Use -----

Purpose -----

Date of Priority -----

Recorded -----

in Book ----- of ----- Page -----

Permit No. 752-1

Water Division No. 1 Belle Fourche River
Water District

Certificate of Completion of Works

TO ALL WHOM IT MAY CONCERN:

This is to Certify, That the Bureau of Sport Fisheries and Wildlife

of Minneapolis, County of Henrepin, and State of Minnesota, the holder of Permit No. 752-1, issued upon Application

No. 752-1, bearing date of priority of April 26, 1965, authorizing the diversion of 1.79 cu. ft. per second of the waters of artesian ground water

County of Lawrence, State of South Dakota, at a point in the NW 1/4 NW 1/4 Section 21, T7N, R1E

for fish culture

purposes, has fully complied with the provisions of the laws of the State of South Dakota relating to proof of completion of the works of diversion set out and described in said Permit; that said works are found in satisfactory condition for diverting and conveying to the place of intended use 2.9 cu. ft.

per second of water; and that the ~~works are found in satisfactory condition~~ use of said water ~~is~~ described as follows,

to-wit: for operation of hatchery facilities in existing diet test building and 24 concrete raceways in the raising of fish.

Witness my hand this 8th day of June A. D. 1967

State Water Resources Commission

By: J. W. GRINES
Chief Engineer, Executive Officer

PROOF OF PUBLICATION

STATE OF SOUTH DAKOTA }
County Lawrence } ss.

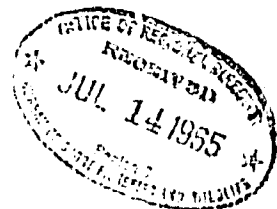

Violet Beckwaldt, Bookkeeper being duly sworn, deposes and says the annexed printed copy of Notice of Intention to Appropriate Water was taken from the -----

Queen City Mail ----- a newspaper which during the whole itme of publication of said notice herein after stated, has been and is printed and published in the

city ----- of Spargfish ----- County of Lawrence ----- and State of South Dakota;

that the said notice was published in said newspaper on the following dates:

June 17, 24, July 1, 8 -----

in each and every issue of the full number thereof, the first publication being made on the 17 day of June

1965 and the last publication on the 8 day of July ----- 1965 -----, upon which days or times

of publication aforesaid the newspaper was regularly published, and that during the whole time of said publication he was Mike Heinbaugh ----- the printer and publisher of the said newspaper.

Violet Beckwaldt -----

Subscribed and sworn to before me this 8 day of July ----- A. D. 1965

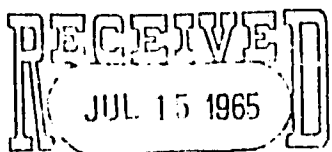

Gertrude M. Baxter -----

Notary Public Lawrence ----- County, S. D.

No. 752-1
(First publication on or before June 17, 1965)
APPROPRIATION OF WATER
Office of State Water Resources Commission.
Pierre, S. Dak. June 7, 1965
Notice is hereby given that the Bureau of Sport Fisheries and Wildlife, whose postoffice address is Minneapolis, Minnesota, has made an application in accordance with the provisions of the water laws of South Dakota for a permit to appropriate for beneficial use 1.74 cubic feet of water per second of time from artesian ground water through the McNenny Fish Hatchery Well, the point of diversion of which is to be located in the NE1/4 of the NE1/4 of Section 20, Twp. 7N, Range 1E. Said water to be used for the purpose of supplies for fish culture and domestic use at the hatchery site.
This application will be taken up by the State Water Resources Commission at their office at Pierre for consideration upon the 14th day of July, 1965, at 2 P.M. All interested persons may appear and be heard.
Appropriate action will be taken by the Water Resources Commission after suitable time has elapsed for the consideration of any or all information presented.
State Water Resources Commission
By: BURTON F. JONES
Water Right Specialist
(193 - 41, J 17-21, Jy 1-8)

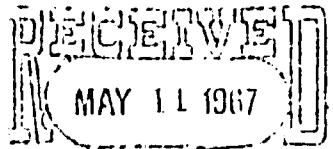

Permit No. _____

Water Division No. _____

STATE WATER RESOURCES COMMISSION
PIERRE SOUTH DAKOTA

NOTICE OF COMPLETION OF WORKS

This blank must be filled out by the holder of permit and forwarded to the Executive Officer at least 60 days before the time set for completion of works

(P. O.) _____

(Date) May 9, 1967

TO THE STATE WATER RESOURCES COMMISSION
OF SOUTH DAKOTA, PIERRE:

DEAR SIR: Notice is hereby given of the completion of the works for the diversion of 1.79
_____ cu. ft. per second of the waters of the state from ground water
through the ten-inch artesian well constructed
for fish cultural _____ purposes
at McLenny National Fish Hatchery, Lawrence Co., S.D. in accordance with the terms and con-
ditions of a certain permit heretofore issued by the Water Resources Commission of the State of South Dakota.

1. The name of the person or corporation holding said permit is R.W. Bursell, Regional Director,
U.S.D.I., Bureau of Sport Fisheries and Wildlife

2. The postoffice address of such person or the place of business of such corporation is 1006 N. Lake Street
County of Hennepin State of Minnesota 55408

3. The number of such permit is 752-1 and the date set for the completion of such work is
July 1, 1966

4. Said water to be used for fish cultural _____ purposes.

5. Said works of diversion will be fully completed on the date set for such completion, and the amount of
water which said works are capable of conducting to the place of intended use, in accordance with the plans ac-
companying the application for such permit, is 1.79 cubic feet per second.

6. The amount of land for which said water is available is 130 acres of fish hatchery _____ facilities,
the water to be used on NW 1/4 NW 1/4 Section 21, T7N, R1E, Lawrence County, South Dakota
for fish cultural purposes.

I hereby certify that the facts set forth in the above notice are true.

John D. Umberger, Regional Engineer

(Signature of Owners) _____

Permit No. 752-1

Water Division No. 1

Water District

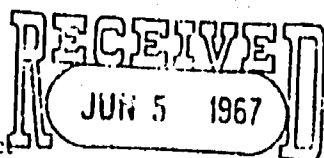

STATE WATER RESOURCES COMM.
PIERRE, SOUTH DAKOTA

Certificate of Examination of Works

Report of Examining Engineer

To the State Water Resources Commission, Pierre, South Dakota:

Dear Sirs: I hereby certify that in accordance with your letter of authorization dated May 26,
19 67, I have this day made a thorough examination of the diversion works constructed by U.S.D.I.,
Bureau of Sport Fisheries and Wildlife, of 1006 West Lake Street, Minneapolis Minn.
in Lawrence County, South Dakota, holder of Permit No. 752-1, issued
upon Application No. 752-1, bearing date of priority of April 26, 19 65, authorizing the
diversion of 1.79 cu. ft. per second of the waters of artesian ground water for fish cultural
purposes. I have to report on the condition of the same as follows:

The diversion works comprise: An 8-inch diameter well, 220 feet deep in the
Spearfish red shale. The well is connected to existing hatchery lines by a
new system of 10-inch transite pipe supply lines equipped with appropriately
placed valves.

and the system is in the following condition: good working condition.

The point of diversion is located NW 1/4 NW 1/4 Section 21, T7N, R1E
Black Hills Meridian, Lawrence County South Dakota

The works are capable of diverting and conveying to the place of use 2.94 cu. ft. per second of water,
which is to be used for fish cultural purposes

The legal subdivisions to be irrigated are: Hatchery facilities in the NW 1/4 NW 1/4 Section 21,
T7N, R1E, Lawrence County, South Dakota. The water is used in the existing Diet
Test Building, Hatchery Building and 24 concrete raceways located on the hatchery site.

comprising a total of 130 acres of land.

The domestic use intended comprises Not applicable

The utilization for power, mining, or other beneficial uses comprises: Not applicable

Witness my hand, this 2 day of June, A. D. 1967

—SEAL—

Edwin B. Stevenson
Examining Engineer.

Edwin B. Stevenson, Acting Regional Engineer
USDI - Bureau of Sport Fisheries & Wildlife
1006 West Lake Street
Minneapolis, Minnesota 55408

OVERSIZE

DOCUMENT IS

SUPPLEMENTARY

TO MICROFILM FILE

SOUTH DAKOTA
**Department of
Water & Natural Resources**

Joe Foss Building
623 East Capitol

Pierre, South Dakota 57501

Water Rights Division 605 773-3352

October 21, 1983

752-1

United State Dept. of Interior
Fish & Wildlife Service
ATTN: Ms. Ginger Chesy-Water Resources Section
Box 25486
Denver Federal Center
Denver CO 80225

Ms. Chesy:

I am in receipt of your letter dated October 6, 1983 concerning Water Right No. 752-1 currently held by Fish & Wildlife Service. In answer to the questions concerning the location and size of the well this can be corrected with a reinspection of the project by a staff member from this office. Upon completion of the reinspection a revised license would be issued with the correct information.

Water Right No. 752-1 was approved July 14, 1965 for 1.79 cubic feet per second. This is all the water that can be diverted under this permit. If the Hatchery is actually diverting 2.9 cubic feet per second from this well a new permit will be necessary for the additional 1.11 cubic feet per second to bring it into compliance with South Dakota Statute. If you have any further questions concerning this matter please call this office.

Thank you,

KEVIN C LARSON
Water Resources Engineer

KCL:ks

enclosure

cc: Jack Merwin
SD Dept. Game, Fish & Parks



United States Department of the Interior
FISH AND WILDLIFE SERVICE

MAILING ADDRESS:
Post Office Box 33486
Denver Federal Center
Denver, Colorado 80225

STREET LOCATION:
134 Union Blvd.
Lakewood, Colorado 80228

IN REPLY REFER TO:

FR/EN
WR SD



OCT 6 1983

South Dakota Department of Water
and Natural Resources Development
Water Rights Division
Joe Foss Building
Pierre, SD 57501

Dear Sirs:

The U.S. Fish and Wildlife Service holds Water License No. 752-1 which has been carried on the books with incorrect data since it was issued.

Please amend these records to reflect the correct information or advise if a particular format is required to facilitate these corrections.

The chronological documentation of Water License No. 752-1 is as follows, reflecting the errors:

The Bureau of Sport Fisheries and Wildlife proposed the construction of an artesian well located in the * NEL/4 NEL/4 Sec. 20 T.7N., R.1E., for fish culture and domestic purposes at the McNenny National Fish Hatchery. The Water Resources Commission approved this application on July 14, 1965, and issued permit with priority date of April 26, 1965.

Notice of Completion of Works was submitted to the Water Resources Commission that the well covered under Permit No. 752-1 had been completed. Notice signed on May 9, 1967.

Notice of Application of Water to Beneficial Use was submitted to the Water Resources Commission that 1.79 cfs of water from well authorized in Permit No. 752-1 was being used beneficially. Notice was signed on May 9, 1967, with attached letter reporting that during the period January-March 1967, the well actually resulted in a total increase of water production at the hatchery of * 2.9 cfs rather than the 1.79 cfs.

The examining engineer of the Bureau of Sport Fisheries and Wildlife submitted a Certificate of Examination of Works certifying that an eight-inch diameter well had been completed in the NW1/4 NW1/4 Sec. 21, T. 7N., R. 1E. and is capable of producing 2.9+ cfs. Certificate signed on June 2, 1967. (Well diameter has been listed as * ten inches in all other documents.)

Certificate of Completion of Works signed on June 8, 1967, certified that the Bureau had furnished proof that works of diversion had been completed to furnish 2.9 cfs of water.

Water License was granted with priority of April 26, 1965 to the Bureau of Sport Fisheries and Wildlife to use 1.79 cfs from a well located in NW1/4 NW1/4 Sec. 21. The license does confirm that the completed system is capable of delivering 2.9 cfs of water to place of use.

- * Correct amount should be 2.9 cfs not 1.79 cfs.
- * Correct location should be NE1/4 NE1/4 Sec. 20 not NW1/4 NW1/4 Sec. 21.
- * Correct size of pipe should be ten-inch not eight-inch.

Since there is no change in actual water use but only an attempt to amend incorrect records, your cooperation in getting these corrections accomplished is appreciated.

If you have any questions or require further information, please call Ms. Ginger Chesy of our Water Resources Section at (303) 234-3616.

Sincerely,



Regional Engineer

cc: Jack Merwin, Secty.
So. Dakota Game, Fish
and Parks Dept.
Sigurd Anderson Bldg.
Pierre, SD 57501

752-1



**DEPARTMENT of ENVIRONMENT
and NATURAL RESOURCES**

JOE FOSS BUILDING
523 EAST CAPITOL
PIERRE SOUTH DAKOTA 57501-3181

APR 23 1993

752A-1

South Dakota Department of Game, Fish & Parks
Tim Olson
523 East Capitol
Pierre, SD 57501

Dear Mr. Olson:

Enclosed is Water License No. 751A-1. This is the final water right document completing your process of obtaining a Water Right.

For your information SDCL 46-6-27 requires that if the owner of an existing well, such as the well authorized by Water Right No. 751A-1, constructs a replacement well and does not plan to use the old well, the old well is considered abandoned and must be plugged. Also, any well that is being used or is not considered abandoned must be valved and controlled, if flowing, or sealed and capped so that no leaking occurs either underground or at the surface.

As long as you use the water beneficially, as stated in the Water License, the State Water Laws provide that you have a continuing right to use the water. If you have any questions, please contact our office.

Very truly yours,

JOHN HATCH, Chief Engineer
Water Rights Program
(605) 773-3352

ks
enclosures

c: Will Saylor, Assistant Hatchery Manager, McNenny State Fish Hatchery, SD Game, Fish & Parks, RR 1, box 205, Spearfish, SD 57783.

NOTE: The applicable portions of Water Right No. 752-1 are incorporated into No. 752A-1.