



**DEPARTMENT of AGRICULTURE  
and NATURAL RESOURCES**

JOE FOSS BUILDING  
523 E. CAPITOL AVE  
PIERRE SD 57501-3182  
danr.sd.gov

**RECOMMENDATION OF ACTING CHIEF ENGINEER FOR WATER PERMIT  
APPLICATION NO. 8085-3, Riverside Hutterian Brethren**

Pursuant to SDCL 46-2A-2, the following is the recommendation of the Acting Chief Engineer, Water Rights Program, Department of Agriculture and Natural Resources concerning Water Permit Application No. 8085-3, Riverside Hutterian Brethren, 40361 200th Street, Huron SD 57350.

The Acting Chief Engineer is recommending APPROVAL of Application No. 8085-3 because 1) there is reasonable probability that there is unappropriated water available for the applicant's proposed use, 2) the proposed diversion can be developed without unlawful impairment of existing domestic water uses and water rights, 3) the proposed use is a beneficial use and 4) it is in the public interest as it pertains to matters of public interest within the regulatory authority of the Water Management Board with the following qualifications:

1. The well approved under Water Permit No. 8085-3 is located near domestic wells and other wells which may obtain water from the same aquifer. The well owner, under this Permit must control withdrawals so there is not a reduction of needed water supplies in adequate domestic wells or in adequate wells having prior water rights.
2. The proposed well authorized by Permit No. 8085-3 must be constructed by a licensed well driller and construction of the well and installation of the pump must comply with Water Management Board Well Construction Rules, Chapter 74:02:04 with the well casing pressure grouted (bottom to top) pursuant to Section 74:02:04:28.
3. This Permit is approved subject to the irrigation water use questionnaire being submitted each year.

See report on application for additional information.

Adam Mathiowetz, PE  
Acting Chief Engineer  
March 20, 2026

**Report to the Chief Engineer on  
Water Permit App. Nos. 8084-3, 8085-3, and 8128-3  
Riverside Hutterian Brethren  
2026 March 16**

In October of 2013, the Water Management Board declared the Tulare: Western Spink-Hitchcock aquifer was fully appropriated. Following legislation in 2014, a procedure was established for prioritizing held applications in aquifers that are fully appropriated. These applications have a priority date of February 25, 2015, and ranks determined by lottery at the May 7, 2015, Board meeting. Figure 1 below is a map of the held applications in this report, nearby applications, and nearby water rights [1], and Water Rights Program observation wells [2]. Table 1 provides details of the water right permits in Figure 1 [1].

Water Permit Application No. 8084-3 proposes to appropriate 3.77 cubic feet of water per second (cfs) from two wells to be completed into the Tulare: Western Spink-Hitchcock aquifer in the approximate centers of the NW  $\frac{1}{4}$  and NE  $\frac{1}{4}$  Section 29 for irrigation of 264 acres in the N  $\frac{1}{2}$  Section 29; all in T112N-R61W. This application is priority of 10 out of 27 on the waitlist and is in Beadle County approximately 6 miles north of Huron, South Dakota.

Water Permit Application No. 8085-3 proposes to appropriate 1.71 cfs from one well to be completed into the Tulare: Western Spink-Hitchcock aquifer in the approximate center of the NW  $\frac{1}{4}$  Section 20 for irrigation of 120 acres located in the NW  $\frac{1}{4}$  Section 20; all in T112N-R61W. This application is priority 4 out of 27 on the waitlist and is in Beadle County approximately 7 miles north of Huron, South Dakota.

Water Permit Application No. 8128-3 proposes to appropriate an additional 2.22 cfs to the diversion rate currently authorized by Water Right No. 2078-3. Water Right No. 2078-3 appropriates 7.25 cfs from 5 wells completed into the Tulare: Western Spink-Hitchcock aquifer in the approximate centers of the NE  $\frac{1}{4}$ , NW  $\frac{1}{4}$ , SW  $\frac{1}{4}$ , SE  $\frac{1}{4}$  Section 28 and NW  $\frac{1}{4}$  Section 21 for irrigation of 792 acres located in Section 28, NW  $\frac{1}{4}$  Section 21 and SW  $\frac{1}{4}$  Section 27; all in T112N-R61W. This application proposes to increase the 7.25 cfs diversion rate authorized under Water Right No. 2078-2 by an additional 2.22 cfs with no increase to the number of irrigated acres. This application, if approved, and Water Right No. 2078-3, would authorize a combined total of 9.47 cfs from five existing wells for the irrigation of 792 acres. This site is located approximately 7 miles northeast of Huron, South Dakota.

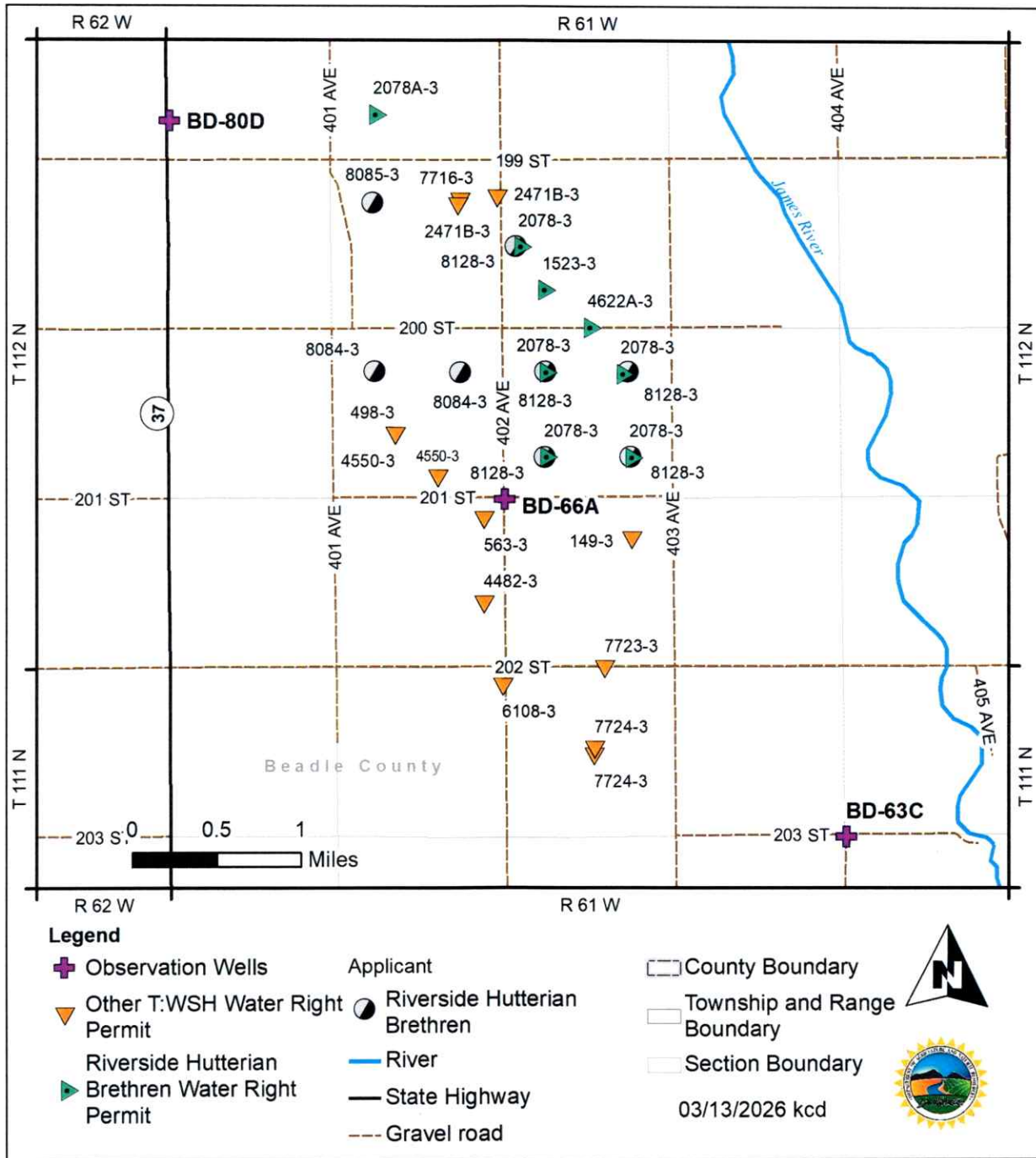

Figure 1: Observation wells and water right permits near these applications. [1] [2]

Table 1: Water right permits and applications shown in Figure 1 [1]

File No.	Name/Business	Status	Use Type	CFS	Acres	Priority
149-3	Leroy Slepikas	License	Irrigation	4.00	320	03/07/1956
498-3	C H/J R Erling	License	Irrigation	4.55	320	09/04/1957
563-3	Leroy/Buell Slepikas	License	Irrigation	4.00	296	01/10/1959
1523-3	Riverside Hutterian Brethren	License	Irrigation	1.71	131	02/20/1968
2078-3	Riverside Hutterian Brethren	License	Irrigation	7.25	792	02/13/1961
2078A-3	Riverside Hutterian Brethren	License	Irrigation	1.44	132	04/03/1974
2471B-3	Buell/Craig Slepikas	License	Irrigation	2.88	202	07/23/1992
4482-3	Denis Slepikas	License	Irrigation	1.78	132	03/06/1980
4550-3	Raymond Oil Company	License	Irrigation	3.77	264	08/14/1980
4622A-3	Riverside Hutterian Brethren	License	Irrigation	1.33	130	03/01/1977
6108-3	Scott & Tammy Slepikas	License	Irrigation	2.72	304	10/20/1998
7716-3	Denis & Craig Slepikas	License	Irrigation	1.67	135	02/08/2013
7723-3	Brent & Leland Kleinsasser	License	Irrigation	2.67	405	02/08/2013
7724-3	Brent & Leland Kleinsasser	License	Irrigation	3.56	300	02/08/2013
8084-3	Riverside Hutterian Brethren	Held	Irrigation	3.77	264	02/25/2015 Rank 10 of 27
8085-3	Riverside Hutterian Brethren	Held	Irrigation	1.71	120	02/25/2015 Rank 4 of 27
8128-3	Riverside Hutterian Brethren	Held	Irrigation	2.22	0	02/25/2015 Rank 1 of 27

**Aquifer: Tulare: Western Spink-Hitchcock**

*Hydrogeologic Characteristics*

The Tulare aquifer is a Quaternary-aged system of sand and gravel layers that were deposited as outwash by meltwater from receding glaciers. The Western Spink-Hitchcock management unit of the Tulare aquifer is a buried aquifer generally lying immediately above the bedrock (a.k.a. basal) [3] [4]. The bedrock is composed of an erosional surface of exposed Cretaceous-aged Pierre Shale and Niobrara Formation, with the lowest erosional surface possibly incising into the Carlile Shale, which contains the Codell Sandstone member [5]. The Niobrara Formation and Codell Sandstone can also be aquifers in portions of South Dakota [2] [1]. The Tulare: Western Spink-Hitchcock aquifer underlies approximately 260,000 acres of Hand, Spink, and Beadle Counties [6] [7]. The Tulare aquifer has an average thickness of 37 feet [8]. Assuming a porosity of 0.15 [9], the estimated recoverable water in storage in the Tulare: Western Spink-Hitchcock aquifer is approximately 1.4 million acre-feet. The Tulare: Western Spink-Hitchcock aquifer is hydrologically connected to several Quaternary and Cretaceous aged aquifers in physical contact with it. Buhler [10] estimated that approximately 77,000 acres of the Tulare: Western Spink-Hitchcock aquifer were under unconfined conditions in October 2012, and showed that at the time, a majority of the aquifer was under confined conditions. The area of the aquifer under confined conditions fluctuates with the amount of water in the aquifer. Since water is essentially incompressible, when the aquifer has more water in storage, more area becomes confined and vice-versa for when there is less water in the aquifer.

The applicant did not submit any well completion reports with these applications, but sufficient information is available to complete the technical analysis for this report. A well completion

report in the SW  $\frac{1}{4}$  Section 29-T112N-R61W completed on October 5, 1957, indicates the well driller encountered sandy yellow clay from 4 to 40 feet below grade, fine sand from 40 to 67 feet, blue clay from 67 to 70 feet, coarse gravel from 70 to the total depth of 102 feet below grade [4]. The driller indicated the static water level was 40 feet below grade at the time the well was completed. Observation Well BD-66A, located near the intersection of 402 Ave and 201 St on Figure 1, has a lithologic log indicating sand was encountered from 45 to the total depth of 97 feet below grade [2]. The average reading for the last 10 years of record has been approximately 40 feet below the top of casing in that well [2]. Excluding readings taken during the irrigation season, the average static water level below the top of casing in that well has been approximately 38 feet below grade over the last 10 years of record [2].

**Applicable South Dakota Codified Law (SDCL)**

Pursuant to SDCL 46-2A-9, a permit to appropriate water may be issued if there is reasonable probability that there is unappropriated water available for the applicant's proposed use, that the proposed diversion can be developed without unlawful impairment of existing domestic water uses and water rights, and that the proposed use is a beneficial use and in the public interest as it pertains to matters of public interest within the regulatory authority of the Water Management Board. This report will only assess the availability of water and possibility of developing this application without unlawful impairment of existing domestic water uses and water rights.

Pursuant to SDCL 46-6-3.1, no application to appropriate groundwater may be approved if, according to the best information reasonably available, it is probable that the quantity of water withdrawn annually from a groundwater source will exceed the quantity of the average estimated annual recharge of the water to the groundwater source. An exception allows water distribution systems to withdraw from groundwater sources older or stratigraphically lower than the Greenhorn Formation regardless of the results of a hydrologic budget. The applicant is not a water distribution system as defined in SDCL 46-1-6(17) and the Tulare: Western Spink-Hitchcock aquifer is younger and stratigraphically higher than the Greenhorn Formation [11]. Therefore, the Water Management Board must find that recharge to the aquifer exceeds withdrawals to approve this application.

Following the October of 2013 Board hearing, the Board determined that the Tulare: Western Spink-Hitchcock aquifer was fully appropriated. In 2014, the South Dakota Legislature established procedure in SDCL 46-2A-7 through 7.1 for holding applications and establishing priority when the Water Management Board declares an aquifer is fully appropriated. This application was submitted prior to February 25, 2015, pursuant to that procedure. The applicant retained eligibility through the first and second five-year reviews. After the second five-year review on December 3, 2025, the Board determined that unappropriated water was available and the applications on hold were to be processed as established by State administrative rule and State law.

**Availability of Water**

*Hydrologic Budget*

The current hydrologic budget of the Tulare: Western Spink-Hitchcock aquifer was presented before the Water Management Board in December of 2025 [12] and is summarized below. The estimated average annual recharge to the aquifer is approximately 0.83 inches per acre [13], which equates to 18,000 ac-ft/yr over the currently estimated extent of the aquifer. Withdrawals from the aquifer are mainly by irrigation from appropriative users. By taking the sum of the average irrigation reported for each permit, Drennon [12] estimated the average annual withdrawal from the aquifer was between 12,000 and 13,000 ac-ft/yr depending on the range of data used. Irrigators have been applying fewer inches per acre as time goes on but irrigating a higher proportion of their permitted acreage in any given year. The estimated average annual withdrawal from irrigation was approximately 12,000 ac-ft/yr for the period of record of 2015 through 2024, which is the last ten years of reports. Based on this hydrologic budget, there is approximately 6,000 ac-ft/yr of unappropriated water available. At the meeting, members of the Water Management Board expressed discomfort at approving the entire 6,000 acre-feet of unappropriated water but did not issue an order specifying an exact amount to which they would limit withdrawals.

For the last ten years of record, the average irrigation per reported acre was 6.63 inches per year and permit holders irrigated 79% of their permitted acres [12]. For the period of record of 1979 through 2024, the average irrigation per reported acre was 8.89 inches per year and permit holders irrigated on average 65% of their permitted acres [12]. The applications in this report request a combined total appropriation of 7.70 cfs for 384 acres of irrigation. Using the above values, their estimated average annual withdrawal is likely to be between 168 to 185 ac-ft/yr. The total withdrawal of the 27 held applications is likely to range between approximately 2,300 to 2,500 ac-ft/yr. Therefore, based on the hydrologic budget, there is reasonable probability that unappropriated water is available for these applications.

Table 2: Estimated withdrawals for the 27 held applications. Several applicants hold multiple applications [12].

Applicant with Held Permit(s)	Total Requested CFS	Total Requested Acres	Est. Withdrawal (ac-ft/yr)	
			6.63 in/yr @ 79% acreage utilization	8.89 in/yr @ 65% acreage utilization
Allen and Jeffrey Gatzke	2.67	110	48	53
Bixler Farms or Bixler Land	16.02	1,450	633	698
Hamilton Family LLC	2.00	145	63	70
Jeff Hamilton	4.00	290	127	140
Ken and Jodi Hofer	4.33	310	135	149
Loren or Cynthia Marzahn	2.22	160	70	77
Martin Anderson	1.86	132	58	64
Riverside Hutterian Brethren	7.70	384	168	185
Scott Hamilton	4.00	435	190	209
Van Buskirk Farms, LLP	25.65	1,798	785	866
<b>Total</b>	<b>70.45</b>	<b>5,214</b>	<b>2,276</b>	<b>2,511</b>

*Observation Wells*

Administrative Rule of South Dakota (ARSD) 74:02:05:07 requires the Water Management Board to rely upon the record of observation well analysis in addition to other information to ensure that recharge to the aquifer exceeds withdrawals. The Water Rights Program maintains 55 observation wells completed into the Tulare: Western Spink-Hitchcock aquifer. The nearest observation wells to the wells for these applications are Observation Wells BD-80D, BD-66A, and BD-63C [2]. The location of those wells with respect to this application is shown in Figure 1 (page 2). The change in behavior of BD-66A is due to the fact that the water level in the well rises such that the well becomes confined. Confined aquifer wells are more reactive to pumping in close proximity and thus the more dramatic reaction to seasonal pumping. These are representative of the general conditions in the aquifer near these applications [2]. Figure 2 shows the water elevations of the three observation wells above. In general, water levels rise during periods of higher-than-average precipitation and decline during periods of lower-than-average precipitation [14]. There is a slight trend of springtime water levels to be increasing with time, consistent with the increased precipitation over time in the area. There are also seasonal declines during the irrigation season. The tendency of the water levels in the aquifer to be primarily influenced by climate and precipitation rather than well withdrawals indicates natural discharge is occurring, which the Water Management Board considers available for capture. Therefore, based on the record of observation wells, there is reasonable probability that unappropriated water is available for these applications.

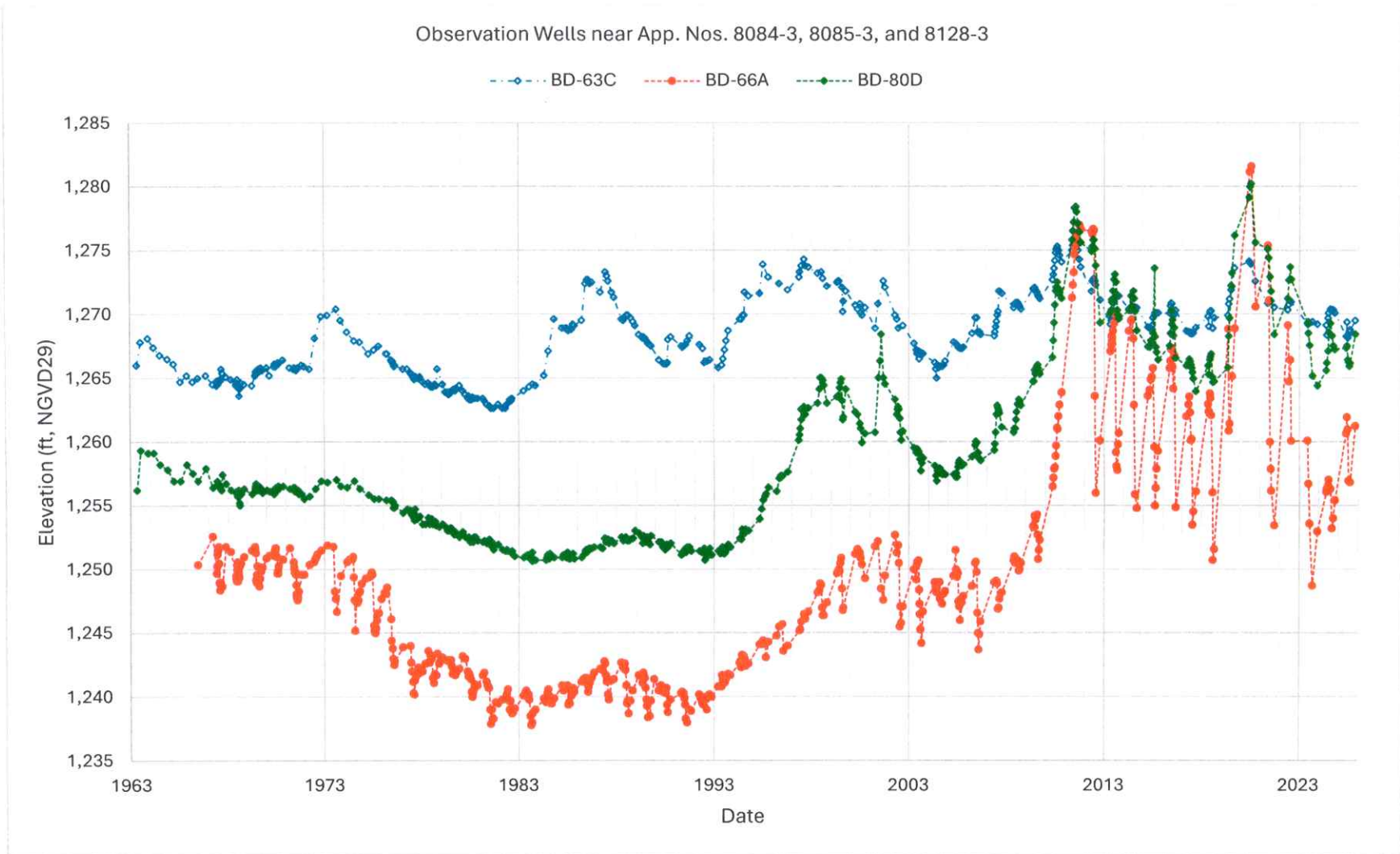

Figure 2: Observation wells near these applications [2]

**Possibility of Unlawful Impairment of Existing Water Rights**

There are several water rights nearby the proposed or existing wells for these applications that are not owned by the applicant [1]. Figure 1 shows the proximity of water rights near these applications. The nearest water right to any of the diversion points is Water Right No. 2471B-3, which is 0.3 miles north of App. No. 8128-3. The nearest domestic well to these applications that is on file with the Water Rights Program and not owned by the applicant is approximately 1 mile south of the southernmost wells for App. No. 8128-3, based on the location provided by the well driller [4].

The Water Rights Program has historically interpreted an unlawful impairment of existing water rights to occur if a junior water right/permit causes a nearby adequate well with a senior water right/permit to become unable to withdraw at the rate it is entitled to or, if a domestic well is impacted, a water right/permit causes an adequate domestic well to be unable to withdraw at the rate needed to supply reasonable domestic use of water. ARSD 74:02:04:20(6) defines an adequate well as:

*...a well constructed or rehabilitated to allow various withdrawal methods to be used, to allow the inlet to the pump to be placed not less than 20 feet into the saturated aquifer or formation material when the well is constructed, or to allow the pump to be placed as near to the bottom of the aquifer as is practical if the aquifer thickness is less than 20 feet*

There are no complaints on file with the Water Rights Program involving possible well interference in the Tulare: Western Spink-Hitchcock aquifer in Beadle County despite the large number of wells in relatively close proximity throughout the Tulare: Western Spink Hitchcock aquifer [15]. Therefore, based on the lack of complaints, there is reasonable probability this application can be developed without unlawful impairment of existing domestic wells or senior water rights.

**Conclusions**

1. Water Permit Application No. 8084-3 proposes to appropriate 3.77 cfs from two wells to be completed into the Tulare: Western Spink-Hitchcock aquifer in the approximate centers of the NW  $\frac{1}{4}$  and NE  $\frac{1}{4}$  Section 29 for irrigation of 264 acres in the N  $\frac{1}{2}$  Section 29; all in T112N-R61W. This application is priority of 10 out of 27 on the waitlist and is in Beadle County approximately 6 miles north of Huron, South Dakota.
2. Water Permit Application No. 8085-3 proposes to appropriate 1.71 cfs from one well to be completed into the Tulare: Western Spink-Hitchcock aquifer in the approximate center of the NW  $\frac{1}{4}$  Section 20 for irrigation of 120 acres located in the NW  $\frac{1}{4}$  Section 20; all in T112N-R61W. This application is priority 4 out of 27 on the waitlist and is in Beadle County approximately 7 miles north of Huron, South Dakota.
3. Water Permit Application No. 8128-3 proposes to appropriate an additional 2.22 cfs to what is currently authorized by Water Right No. 2078-3. Water Right No. 2078-3 appropriates 7.25 cfs from 5 wells completed into the Tulare: Western Spink-Hitchcock

aquifer in the approximate centers of the NE ¼, NW ¼, SW ¼, SE ¼ Section 28 and NW ¼ Section 21 for irrigation of 792 acres located in Section 28, NW ¼ Section 21 and SW ¼ Section 27; all in T112N-R61W. This application proposes to increase the 7.25 cfs diversion rate authorized under Water Right No. 2078-2 by an additional 2.22 cfs with no increase to the number of irrigated acres. This application, if approved, and Water Right No. 2078-3, would authorize a combined total of 9.47 cfs from five existing wells for the irrigation of 792 acres.

4. The Water Management Board determined in December of 2025, that based on the hydrologic budget and observation well analysis, there is reasonable probability unappropriated water is available for this application.
5. There is reasonable probability this application can be developed without unlawful impairment of existing water rights and domestic uses.



Kimberly C. Drennon, E.I.  
Engineer III – DANR Water Rights Program

#### References

- [1] Water Rights Program, "Water Right Permit Files," S.D. Dept. of Ag. and Nat. Resources, Pierre, South Dakota, 2026.
- [2] Water Rights Program, "Observation Wells," S.D. Dept. of Ag. and Nat. Resources, Pierre, South Dakota, 2026.
- [3] SD DANR Geological Survey Program, "Lithologic Logs," Vermillion, South Dakota, 2025.
- [4] Water Rights Program, "Well Completion Reports," S.D. Dept. of Ag. and Nat. Resources, Pierre, South Dakota, 2026.
- [5] D. W. Tomhave and L. D. Schulz, "Bedrock geologic map showing configuration of the bedrock surface in South Dakota east of the Missouri River," DANR Geological Survey Program, Vermillion, SD, 2004.
- [6] J. Farmer, "First Report on the Five Year Review of Water Availability Western Spink Hitchcock Management Unit of the Tulare Aquifer," SD DANR Water Rights Program, Joe Foss Bldg., Pierre, South Dakota, 2020.
- [7] T. Jensen and A. Mathiowetz, "Report to the Chief Engineer on Water Permit Application Nos. 8949-3 & 8950-3 Tom Tuhsbaumer & 8951-3 Tyson Nuhsbaumer," SD DANR Water Rights Program, Joe Foss Bldg., Pierre, SD., 2025.

- [8] R. D. Benson, "Major aquifers in Spink County, South Dakota," SD DANR Geological Survey Program, Vermillion, South Dakota, 1997.
- [9] L. S. Hedges, S. L. Burch, D. L. Iles, R. A. Barari and R. A. Schoon, "Evaluation of Ground-Water Resources Eastern South Dakota and Upper Big Sioux River, South Dakota and Iowa Tasks 1-4," US Army Corps of Engineers, Omaha, Nebraska, 1982.
- [10] K. Buhler, "Report to the Chief Engineer on Water Permit Application Nos. 7858-3, 7859-3, 7860-3, 7861-3, 7863-3 through 7872-3, 7885-3, 7894-3," SD DANR Water Rights Program, Joe Foss Bldg. Pierre, South Dakota, 2013.
- [11] M. D. Fahrenbach, F. V. Steece, J. F. Sawyer, K. A. McCormick, G. L. McGillivray, L. D. Schulz and J. A. Redden, "South Dakota Stratigraphic Correlation Chart," SD Dept. of Ag. and Nat. Res. Geologic Survey Program, Vermillion, SD, 2010.
- [12] K. C. Drennon, "Second Report on the Five-Year Review of Water Availability in the Western Spink-Hitchcock Management Unit of the Tulare Aquifer," SD DANR Water Rights Program, 3 December 2025. [Online]. Available: [https://danr.sd.gov/wrimage/pub/2025\\_TWESH\\_5YR.pdf](https://danr.sd.gov/wrimage/pub/2025_TWESH_5YR.pdf). [Accessed 19 February 2026].
- [13] L. K. Kuiper, "Appraisal of the Water Resources of the Eastern Part of the Tulare Aquifer, Beadle, Hand, and Spink Counties, South Dakota," US Geological Survey, Huron, South Dakota, 1984.
- [14] NOAA National Centers for Environmental Information, "Climate at a Glance: Divisional Time Series," U. S. National Oceanic and Atmospheric Administration, 1 March 2026. [Online]. Available: <https://www.ncei.noaa.gov/access/monitoring/climate-at-a-glance/divisional/time-series>. [Accessed 19 March 2026].
- [15] Water Rights Program, "Complaints Database," S.D. Dept. of Ag. and Nat. Resources, Joe Foss Building, Pierre, SD, 2025.

Report on Water Permit App. Nos. 8084-3, 8085-3, and 8128-3

**Appendix: Table of Held Permits**

Table 3: All 27 held permits from the Tulare: Western Spink-Hitchcock aquifer

App No.	Name	Priority	New CFS	New Acres	Existing associated permit	Existing CFS	Existing Acres	Total CFS	Total Acres	No. New Wells	No. Existing Wells	Description of Diversion Points	Lands Irrigated
8128-3	Riverside Hutterian Brethren	1	2.22	0	2078-3	7.25	792	9.47	792	0	5	Approx. ctrs of NW 1/4, NE 1/4, SW 1/4, SE 1/4 Sec. 28, W 1/2 W 1/2 Sec. 21; all in T112N-R61W	4 @ 132 acres for 528 acres in Sec. 28; 132 acres in NW 1/4 Sec. 21
8101-3	Bixler Farms	2	1.78	150	N/A	N/A	N/A	1.78	150	1	0	Approx. ctr of SW 1/4 Sec. 18 T114N-R62W	150 acres SW 1/4 Sec. 18
8137-3	Ken and Jodi Hofer	3	2.22	160	N/A	N/A	N/A	2.22	160	1	0	Approx. ctr of NE 1/4 Sec. 21 T113N-R62W	160 acres NE 1/4 Sec. 21
8085-3	Riverside Hutterian Brethren	4	1.71	120	N/A	N/A	N/A	1.71	120	1	0	Approx. ctr of NW 1/4 Sec. 20 T112N-R61W	160 acres in NW 1/4 Sec. 20
8120-3	Martin Anderson	5	1.86	132	N/A	N/A	N/A	1.86	132	1	or 1	Approx. ctr of Sec. 18 T113N-R62W	132 acres S 1/2 Sec. 18
8131-3	Scott Hamilton	6	2.00	290	N/A	N/A	N/A	2.00	290	1	0	Approx. ctr of SE 1/4 Sec. 10 T113N-R65W	290 acres E 1/2 Sec. 10
8138-3	Ken and Jodi Hofer	7	2.11	150	N/A	N/A	N/A	2.11	150	1	0	Approx. ctr of SE 1/4 Sec. 31 T113N-R62W	150 acres SE 1/4 Sec. 31
8106-3	Bixler Land	8	1.78	160	N/A	N/A	N/A	1.78	160	1	0	Approx. ctr of NE 1/4 Sec. 24 T114N-R63W	160 acres NE 1/4 Sec. 24
8103-3	Bixler Land	9	1.78	160	N/A	N/A	N/A	1.78	160	1	0	Approx. ctr of SW 1/4 Sec. 23	160 acres SW 1/4 Sec. 23
8084-3	Riverside Hutterian Brethren	10	3.77	264	N/A	N/A	N/A	3.77	264	2	0	Approx. ctrs of NW 1/4, NE 1/4 Sec. 29 T112N-R61W	2 @ 132 acres for 268 acres in N 1/2 Sec. 29
8105-3	Bixler Land	11	1.78	160	N/A	N/A	N/A	1.78	160	1	0	Approx. ctr of SE 1/4 Sec. 24 T114N-R63W	160 acres SE 1/4 Sec. 24
8129-3	Jeff Hamilton	12	2.00	145	N/A	N/A	N/A	2.00	145	up to 2	0	E 1/2 NW 1/4 Sec. 6 T113N-R64W	145 acres NW 1/4 Sec. 6
8099-3	Bixler Farms	13	1.78	160	N/A	N/A	N/A	1.78	160	1	0	Approx. ctr of NW 1/4 Sec. 3 T114N-R63W	160 acres NW 1/4 Sec. 3
8111-3	Van Buskirk Farms, LLP	14	1.94	136	N/A	N/A	N/A	1.94	136	1	0	Approx. ctr of NE 1/4 Sec. 36 T113N-R64W	136 acres NE 1/4 Sec. 36
8133-3	Scott Hamilton	15	2.00	145	N/A	N/A	N/A	2.00	145	up to 2	0	NE 1/4 NE 1/4 Sec. 11 T113N-R65W	140 acres NE 1/4 Sec. 11
8102-3	Bixler Land	16	1.78	160	N/A	N/A	N/A	1.78	160	1	0	Approx. ctr of SE 1/4 Sec. 22 T114N-R63W	160 acres SE 1/4 Sec. 22

Report on Water Permit App. Nos. 8084-3, 8085-3, and 8128-3

App No.	Name	Priority	New CFS	New Acres	Existing associated permit	Existing CFS	Existing Acres	Total CFS	Total Acres	No. New Wells	No. Existing Wells	Description of Diversion Points	Lands Irrigated
8108-3	Van Buskirk Farms, LLP	17	14.00	982	N/A	N/A	N/A	14.00	982	4	0	Approx. ctrs of Sec. 31, SW 1/4 Sec. 30, NE 1/4 Sec. 32 T114N-R63W; NE 1/4 Sec. 36 T114N-R64W	574 acres Sec. 31, 136 each SW 1/4 Sec 30, NW 1/4 Sec 32, NE 1/4 Sec. 36
8110-3	Van Buskirk Farms, LLP	18	1.94	136	N/A	N/A	N/A	1.94	136	1	0	Approx. ctr of NW 1/4 Sec. 33 T114N-R63W	136 acres Sec. 33
8100-3	Bixler Farms	19	1.78	160	N/A	N/A	N/A	1.78	160	1	0	Approx. ctr of SW 1/4 Sec. 24 T115N-R63W	160 acres SW 1/4 Sec. 24
8121-3	Allen and Jeffrey Gatzke	20	0.89	40	N/A	N/A	N/A	0.89	40	1	0	Approx. ctr of NW 1/4 SW 1/4 Sec. 13 T114N-R63W	40 acres SW 1/4 Sec. 13
8130-3	Jeff Hamilton	21	2.00	145	N/A	N/A	N/A	2.00	145	up to 2	0	W 1/2 NE 1/4 Sec. 6 T113N-R64W	145 acres NE 1/4 Sec. 6
8107-3	Bixler Farms	22	1.78	180	3052-3	1.88	140	3.66	320	1	1	new well in NW 1/4 Sec. 6, existing well in NE 1/4 SW 1/4 Sec. 6 T114N-R62W	180 additional acres in Sec. 6
8122-3	Allen and Jeffrey Gatzke	23	1.78	70	N/A	N/A	N/A	1.78	70	1	0	Approx. ctr of SE 1/4 Sec. 13 T114N-R63W	70 acres E 1/2 SE 1/4 Sec. 13
8109-3	Van Buskirk Farms, LLP	24	7.77	544	N/A	N/A	N/A	7.77	544	4	0	Approx. ctrs of SE 1/4, SW 1/4 Sec. 4, NE 1/4 SE 1/4 Sec. 5; all in T113N-R63W	4 @ 136 acres in S 1/2 Sec. 4, E 1/2 Sec. 5
8135-3	Loren or Cynthia Marzahn	25	2.22	160	N/A	N/A	N/A	2.22	160	1	0	Approx. ctr of NE 1/4 Sec. 28 T115N-R63W	160 acres NE 1/4 Sec. 28
8104-3	Bixler Farms	26	1.78	160	N/A	N/A	N/A	1.78	160	1	0	Approx. ctr of SE 1/4 Sec. 35 T115N-R63W	160 acres SE 1/4 Sec. 35
8132-3	Hamilton Family LLC	27	2.00	145	N/A	N/A	N/A	2.00	145	up to 2	0	Approx. ctr of the SW 1/4 Sec. 15 T113N-R65W	145 acres SW 1/4 Sec. 15