

Oil and Gas Well, Test Hole, and Permit Locations with Field Boundaries, Harding County, SD

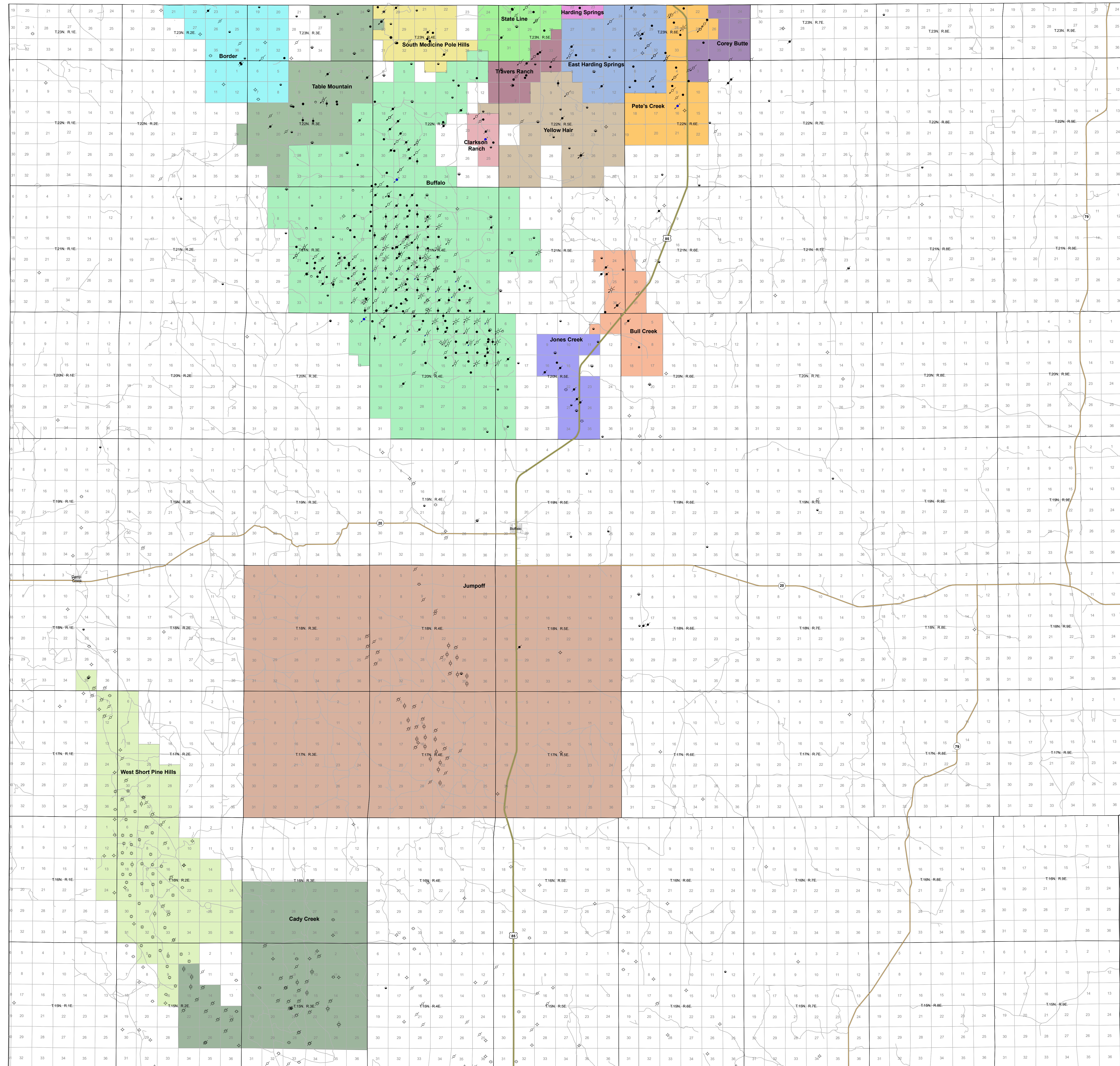

EXPLANATION

- | | |
|---------------------------------|----------------------------------|
| Oil Fields | Well Symbols |
| Border Field | New permit |
| Buffalo Field | Never drilled |
| Bull Creek Field | Gas well - producing |
| Clarkson Ranch Field | Gas well - plugged and abandoned |
| Corey Butte Field | Gas well - temporarily abandoned |
| East Harding Springs Field | Oil well - producing |
| Harding Springs Field | Oil well - plugged and abandoned |
| Jones Creek Field | Oil well - temporarily abandoned |
| Pete's Creek Field | Dry hole |
| South Medicine Pole Hills Field | Dry hole - gas show |
| State Line Field | Dry hole - oil show |
| Table Mountain Field | Dry hole - oil and gas show |
| Travers Ranch Field | Reservoir monitoring well |
| Yellow Hair Field | UIC - injecting |
| | UIC - plugged and abandoned |
| | UIC - temporarily abandoned |
| | UIC - water supply for injection |

Gas Fields

- Cady Creek Field
- Jumpoff Field*
- West Short Pine Hills Field

Other Symbols

- US highway
- State highway
- Road

* The Jumpoff Field as delineated was created for the purposes of reporting production data only. The Board of Minerals and Environment has not officially designated this area as a field.

Scale: 1:100,000

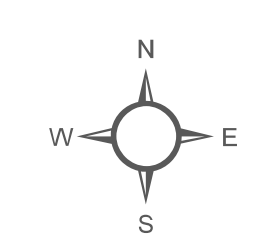
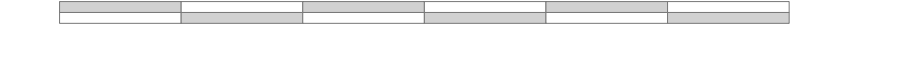

Compiled by DANDR's Geological Survey Program, January 2022
The State of South Dakota (State) makes no claims, promises, or guarantees about the absolute accuracy, completeness, or adequacy of this data. The use of this data is limited to informational and educational purposes only. This data is provided as is and in no event or circumstance shall the State, nor any agency, employee or representative be liable for any damages or losses, including without limitation, damages resulting from lost profits or revenue, claims by third parties or any special, incidental, punitive or consequential damages, arising out of the use of this data. The State may make changes to information at any time to add, update, or correct the information provided. Any errors or omissions should be reported for investigation. Any person or entity that relies on information obtained from this map does so at his or her own risk.